

ADU Special

Designed for close-tolerance holes, in a single pass, or “one up” drilling operations, our Double Margin (DM) drill can be manufactured with coolant holes or with a solid body.

The double margin construction enhances stability in the hole for close-tolerance drilling in a single pass. This makes it ideal for Advanced Drilling Units (ADUs) that require bushings in the setup. With a total of four margins, the enhanced stability in the bushing allows the ADU setup to produce high quality, close-tolerance holes.

Recommended point geometries, along with AMAMCO’s close tolerances, allow the drill to be self-centering. This eliminates the need for spot drilling.

With broad design flexibility from the point geometry to the shank, AMAMCO can custom manufacture this drill in an almost unlimited number of configurations, depending on your application.

FOR A CUSTOM DOUBLE MARGIN DRILL for your specific application, please contact AMAMCO at sales@amamcotool.com or 1-800-833-2239.

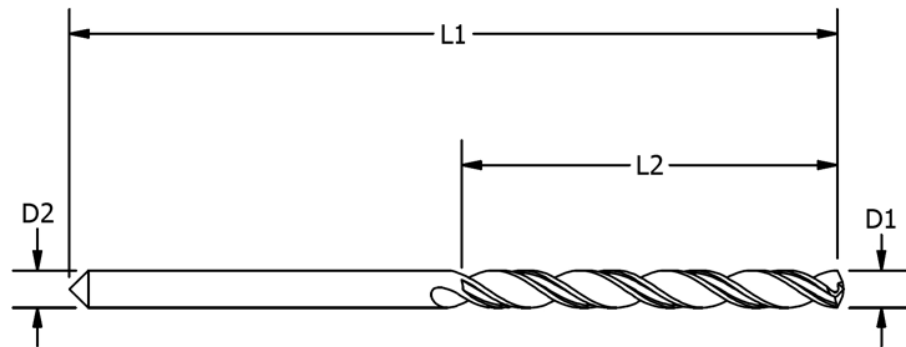
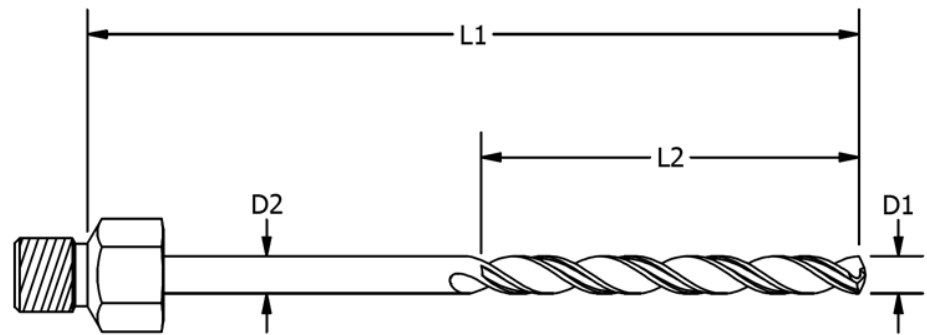

Do more with less.
Not often is this true.

Creating a tool that combines two or three steps into one is no easy task.

In response to the constant need for greater efficiency, AMAMCO has developed a single cutting tool that can combine two or three steps into one. Drill, Counter bore, and Countersink.

AMAMCO's application-specific approach accommodates the complexities of torque increase at the transition from drill to counter bore and/or countersink, as well as the special demands of materials such as aluminum, titanium, or composite materials (individually and in stacks).

When needed, this tool can be designed with coolant holes to maximize performance and tool life.

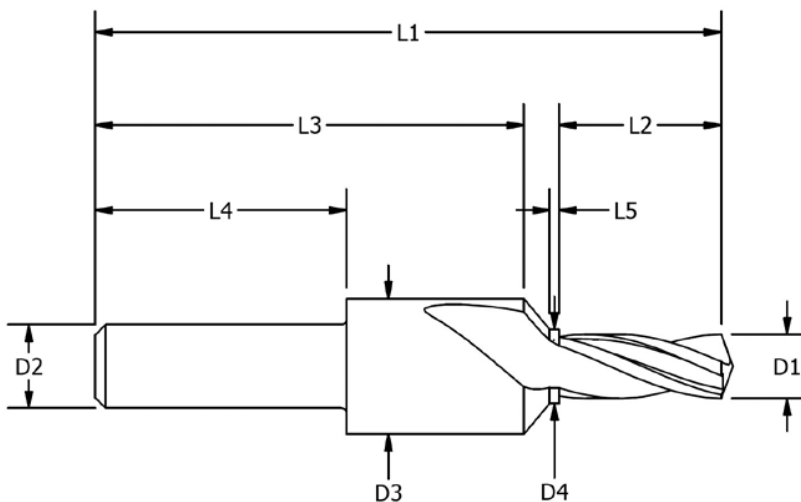
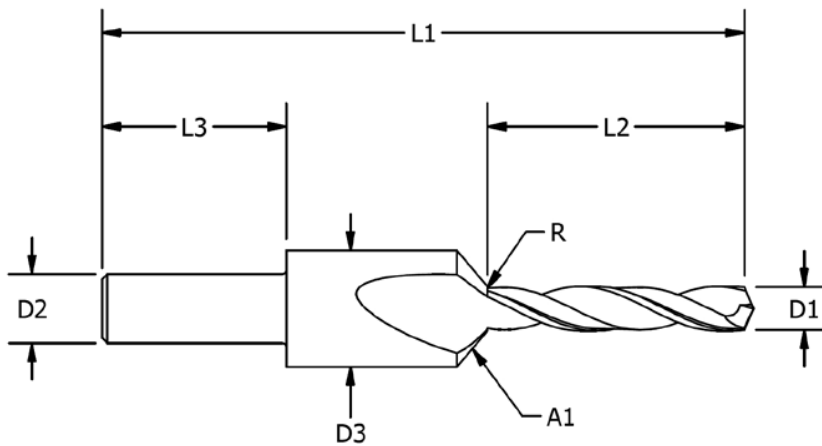

**FOR A CUSTOM DRILL
COUNTERSINK AND
DRILL COUNTER BORE
COUNTERSINK for your
specific application,
please contact AMAMCO
at sales@amamcotool.com
or 1-800-833-2239.**